

# AREA PLAN

## 9 KINGSWAY

LONDON WC2B

### Ground Floor

#### Net Internal Area

<span style="color: cyan;">■</span>	OFFICE	150.6 sq m	1621 sq ft
<span style="color: lightblue;">■</span>	RETAIL	225.0 sq m	2421 sq ft
<span style="color: purple;">■</span>	RECEPTION	23.0 sq m	243 sq ft

**TOTAL NIA: 398.6 sq m 4290 sq ft**

The following has been INCLUDED in the TOTAL NIA:

Ramp	5.3 sq m	57 sq ft
------	----------	----------

The following has been EXCLUDED from the TOTAL NIA:

E.S.G. - Electrical Switch Gear	0.2 sq m	2 sq ft
Staff Toilets	7.6 sq m	82 sq ft
Unusable	0.1 sq m	1 sq ft

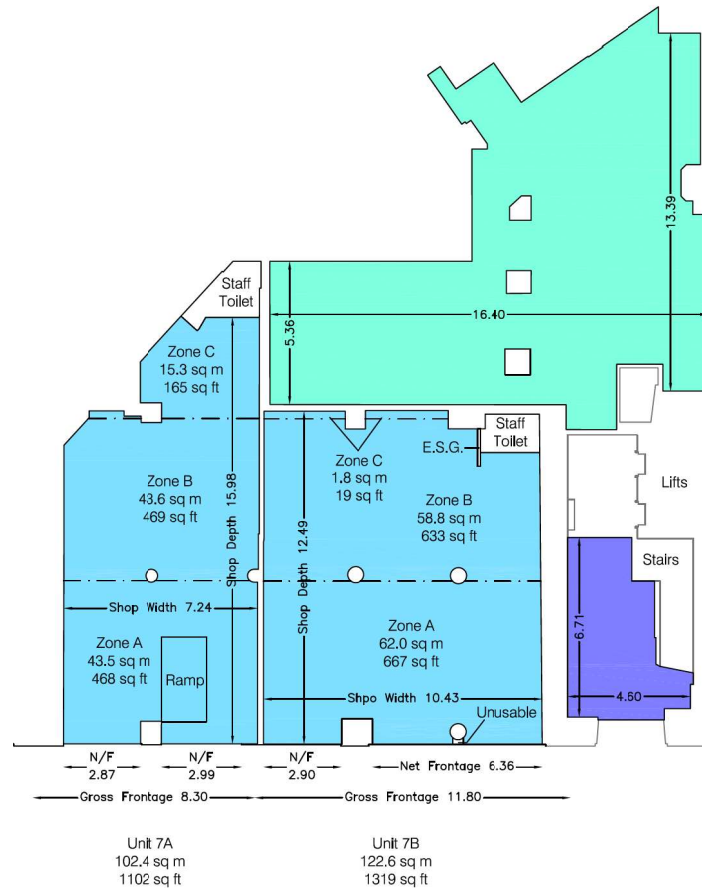

KINGSWAY

**Dwg No. 34434-AG**

Issue B

October 2015

Scaled for presentation purposes

**Plowman Craven**  
Regulated by RICS



+44(0)1582 765566 www.plowmancraven.co.uk

**Condition of Site:**

**Occupied**  
Vacant  
**Heavy Fit-Out**  
Shell & Core  
Under Construction  
Cat A Fit-Out

**Notes:**

This drawing complies with the 6th edition of the RICS code and indicates the extent of the areas quoted, produced to an accuracy commensurate with standard presentation scales. It is held in a scaled digital CAD format.

The office element of this drawing was last issued as 29553-AG issue A dated July 2013. Dwg. No. changed for report amalgamation. No site visit for verification of office areas has been undertaken.

**Revisions:**

A - Original Issue (September 2015)  
B - Ground Floor Office Area Included for Report Amalgamation (October 2015)